

# YJ200

*Elevator Traction Machine*  
*Machines de traction ascenseurs*

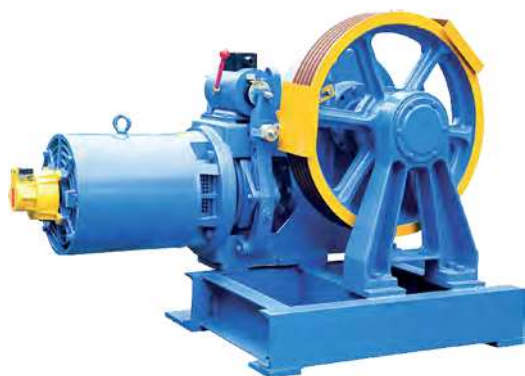

<i>Suspension</i>	<b>1:1</b>	<i>Suspension</i>
<i>Control</i>	<b>AC2, VVVF</b>	<i>Contrôle</i>
<i>Brake (DZE-12E)</i>	<b>DC110V 2 A</b>	<i>Frein (DZE-12E)</i>
<i>Weight</i>	<b>650 kg</b>	<i>Poids</i>
<i>Max. Static Load</i>	<b>6 000 kg</b>	<i>Charge stat. maxi.</i>

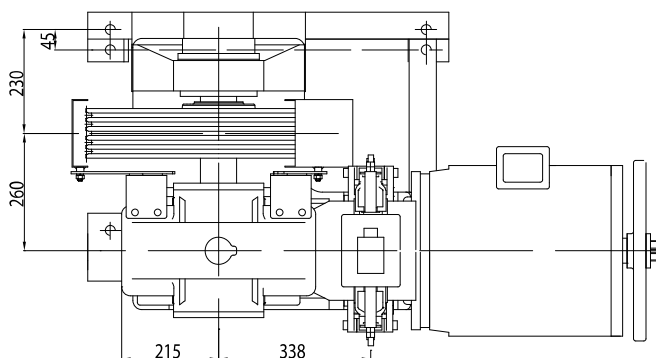
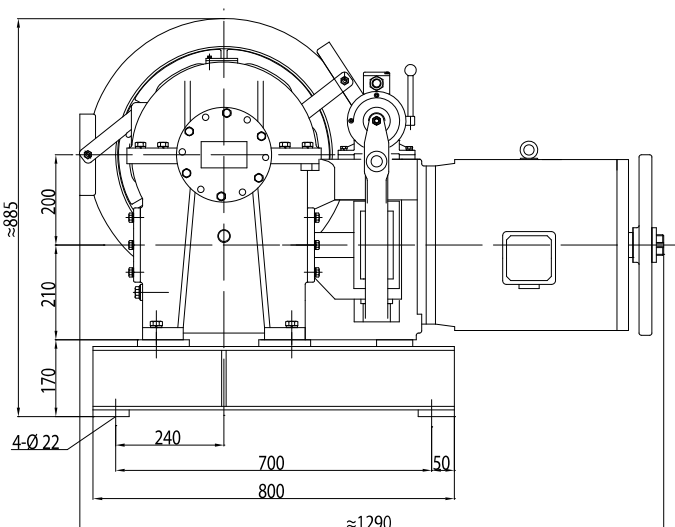
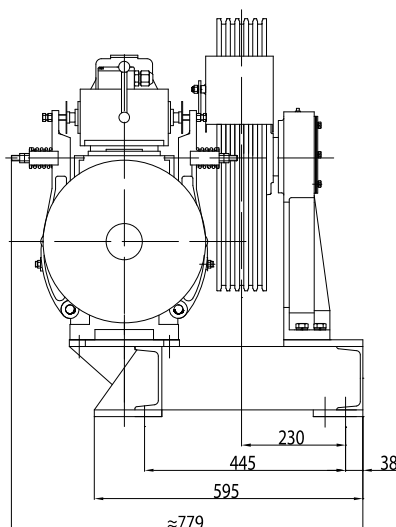

<i>Load Charge</i>	<i>Speed Vitesse</i>	<i>Ratio</i>	<i>ø Sheave ø Poulie</i>	<i>Rope sheave Câbles</i>	<i>Power Puissance</i>	<i>Pole</i>
(kg)	(m/s)		(mm)	(mm)	(kW)	
1000	0,5	53:1	Ø 530	5XØ13X20	7,5	6
1000	1,0	41:1	Ø 530	5XØ13X20	11	4
1000	0,5	53:1	Ø 530	5XØ13X20	7,5/1,5	6/24
1000	1,0	41:1	Ø 530	5XØ13X20	11/2,5	4/16

*Left sheave type is optional.*  
*Incremental encoder.*  
*Poulie à gauche possible*  
*Codeur incrémental.*